

SERIES 90

MODEL 904LV

3-Piece Ball Valve

Tube / Pipe
(3/8" - 4")



Pressure Rating PN64 (3/8"-2")
PN50 (2 1/2"-4")

Material EN10213-1.4408, ASTM A351-CF8M

Seat TFM1600

Bore Type Pipe end: Full bore, Tube end: Standard bore

Additional Features

- Oil-free product
- Pipe end: 5S (SCH5), 10S (SCH10)
- AP Grade (Ra ≤ 0.8µm), BA Grade (Ra ≤ 0.25µm)
- ISO 5211 direct mounting pad
- Able to add anti-static device (Ball-stem-body)
- Purge port (Optional)

MATERIALS LIST

NO.	PART NAME	Q'TY	MATERIAL
1	BODY	1	1.4408 (CF8M)
2	END CAP	2	1.4409 (CF3M)
3	BALL	1	SUS316
4	STEM	1	SUS316
5	SEAT	2	TFM1600
6	STEM SEAL	1	R.PTFE
7	V-RING PACKING	1SET	PTFE
8	BUSHING	1	50% S.S. POWDER FILLED PTFE
9	O-RING	1	VITON
10	STEM NUT	2	SUS304
11	GLAND	1	SUS304
12	BELLEVILLE WASHER	2	SUS304
13	BOLT	4~6	SUS304
14	WASHER	4~12	SUS304
15	BOLT NUT	4~12	SUS304
16	LOCK SADDLE	1	SUS304
17	WASHER	1	SUS304
18	HANDLE	1	SUS304
19	HANDLE SLEEVE	1	VINYL
20	STOP PIN	1	SUS304
21	STOP PIN NUT	1	SUS304
22	PURGE PORT	0~2	SUS304

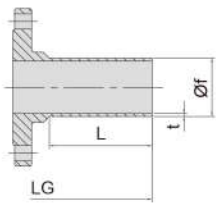
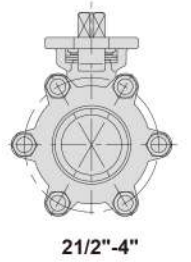
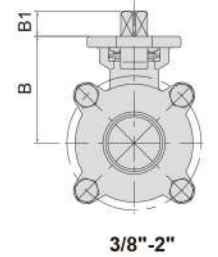
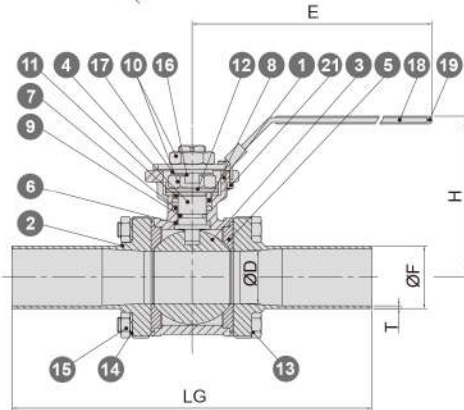
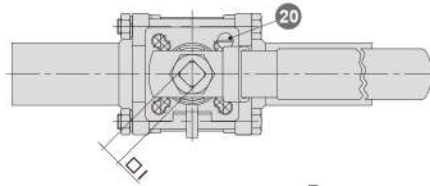
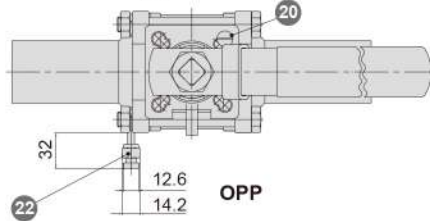
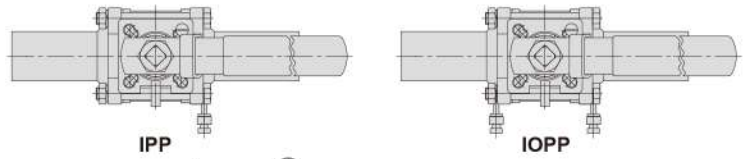

Tube End

Pipe End

DIMENSIONS (mm)

SIZE	B	B1	t	E	Øf	ØD	ØF	H	□I	L	T		LG	ISO 5211	
											5S	10S			
3/8"	10A	40.2	9	-	128	-	9.6	17.3	70.5	9	-	1.24	1.65	125.4	F03 F04
1/2"	15A	40.2	9	1.65	128	12.7	15	21.7	70.5	9	39	1.65	2.1	150.8	F03 F04
3/4"	20A	43.4	9	1.65	128	19.05	20	27.2	73.8	9	41.8	1.65	2.1	155.7	F03 F04
1"	25A	52	14	1.65	167	25.4	25	34	85.4	11	43.4	1.65	2.8	186.2	F04 F05
1 1/4"	32A	56.5	14	1.65	167	31.8	32	42.7	90	11	50	1.65	2.8	195.6	F04 F05
1 1/2"	40A	65.7	15.5	1.65	215	38.1	38	48.6	99.6	14	54.4	1.65	2.8	231.6	F05 F07
2"	50A	73.95	15.5	1.65	215	50.8	50	60.5	107.8	14	46.8	1.65	2.8	243.4	F05 F07
2 1/2"	65A	94	16.5	1.65	322	63.5	65	76.3	145.7	17	71	2.1	3.0	290.2	F07 F10
3"	80A	102	16.5	1.65	322	76.2	80	89.1	154.7	17	72	2.1	3.0	302.2	F07 F10
4"	100A	132	21.5	2.11	320	101.6	100	114.3	188	22	70	2.1	3.0	326.2	F10

SERIES 10

SERIES 20

SERIES 30

SERIES 70

SERIES 85

SERIES 90

SERIES 95

SERIES MPY / MP

OTHER VALVES AND VALVE PARTS

PRESSURE-TEMPERATURE RATINGS